

EXCEPTIONAL, DOWN TO THE LAST BOLT.

If there is one word that best defines our module, it is “purposeful”. Everything that goes into it, from skin to seam, is there to make your experience exceptionally delightful.

If you’re one of those who loves to get into the nuts and bolts of things, here’s everything you need to know about what goes into a MODULI module.

The Frame:

The frame is the structural exoskeleton of a module, around which everything else is constructed. A module's frame consists of proprietary-designed floor & roof structures, pillars, and ISO corners, each of which is designed and manufactured using in-house shapes and sections that provide strength, and allows for co-joining & organising services.

Steel plates are sheered, punched, and shaped into the appropriate forms before they are welded to make the required frame structure.

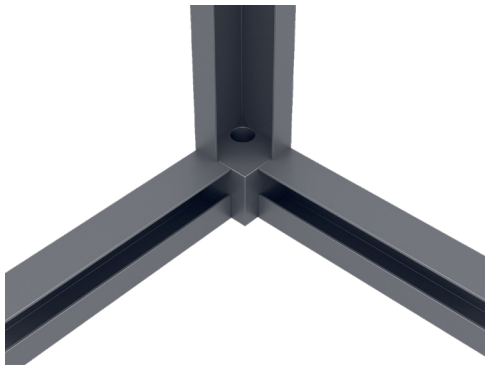

Vertical Corner Joint — Bottom Side



Vertical Corner Joint — Top Side

The design and structure of the frame provides for:

- High structural integrity required for mobility and reusability
- Load-bearing capacity, for stacking up to 3 modules
- Resistance against environmental factors

Each frame is shot-blasted, smoothed, and painted with exterior grade, corrosion-resistant paint, to ensure the module can withstand any weather condition for decades.

The Skin:

The skin of a module comprises of an integrated, multi-layered panel. These layers are primarily:

The Outer Layer:

The outer layer is formed of a metal sheet designed in-house using a special zinc alloy, which can be painted in any colour that matches your style. This layer is what provides protection against the sun, heat, rain, dust, and other natural elements. The hardworking outer layer is practically maintenance-free, needing a paint job once every decade or two.

The Insulation:

Mineral-wool provides unbeatable thermal and sound insulation that cocoons you in a quiet and comfortably cool bubble.

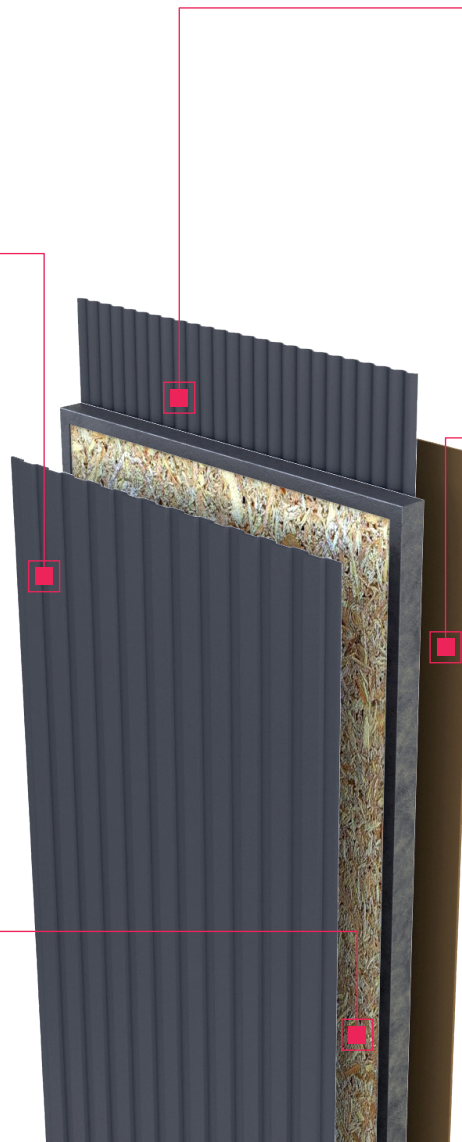

The Vapour Barrier:

A synthetic barrier with unique vapour permeability characteristics allows water vapour trapped inside the module to escape, while preventing any water from permeating into it.

The Inner Layer:

Walls & Ceilings: Impact- and water-resistant gypsum boards form the inner layer of the walls and ceiling. They can be painted to the colour of your choosing.
Floors: Cement particle boards form the floor base onto which flooring tiles are added to provide the ideal flooring finish.

All internal surface finishes can be customised to meet your unique taste and aesthetic sense. All our materials are carefully-selected for their specific properties of fire-, water- & impact-resistance, and impeccable aesthetics.

The Unification:

Ever heard of the phrase — 'greater than the sum of its parts'? We think that it was inspired by our modules. After all, their versatility increases multi-fold when co-joined to form larger and more grander spaces. Simple yet sophisticated, modules allow you to do what you want, where you want.

With MODULI, this adaptability comes seamlessly as well.

The ISO corners on the frames are designed to easily co-join modules together, just like Lego blocks. Concealed hooks and fasteners within the ISO corners ensure clean, clutter-free connections.

Additionally, specially-designed weatherproof EPDM gaskets embedded along the length of the joints between modules provide watertight connections.

And if you ever want to pack-up and move, your MODULI structure is ready to move with you. It's as simple as untying and unbolting the connectors between the modules, thereby allowing each individual module to be transported and reassembled wherever you desire. When you're on the move, MODULI follows.

There's a simple reason why we've put so much thought into designing the module — it's so that you don't have to give it a second thought.

Corner Sealing



Modules Locking

